

Thank you for choosing the SenSura® Mio Convex Flip ostomy pouching system.

This leaflet contains instructions for using SenSura Mio Convex Flip – a 2-piece ostomy pouching system, that consists of a barrier and a pouch.

The pouch is intended to collect output from a stoma.

The barrier is intended to fix the pouch and adhere to intact skin around the stoma.

At Coloplast, we know how challenging it can be to find a solution that fits your individual body shape. For people with bulges in the area around the stoma, it can be especially difficult. That's why we developed a curved barrier for those with a stoma placed on top of a bulge. A first of its kind, a unique curved star-shaped barrier helps to minimize the formation of creases and folds in the barrier and provides a comfortable fit.

We encourage you to read these instructions for use, and to save them for future reference.



Instruction for use also available on video

To see the instruction video you can either scan the QR code or go to

www.coloplast.us/convexflip/video/barrier

How to prepare the barrier

1

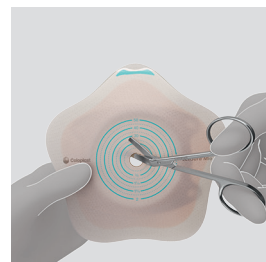

Cut the barrier to fit your stoma

Cut a hole in the barrier to fit the exact size and shape of the stoma using a pair of small curved scissors and the cutting guide on the barrier.

You can use the enclosed stoma measuring guide to measure the size and shape of the stoma.

Your stoma shape can change so it is recommended that you measure it when it is biggest. This is often when you sit down.

An exact fit between the hole and the stoma is important to reduce the risk of leakage and skin problems.

2

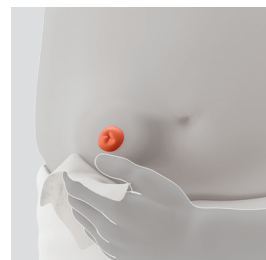

Clean before application

Thoroughly clean the stoma and the surrounding skin area.

The skin must be completely dry before application of the barrier.

How to apply the barrier

3

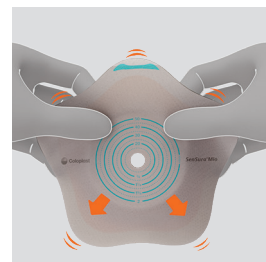

Flip the barrier ...

Flip all 5 petals to prepare the barrier for application.

4

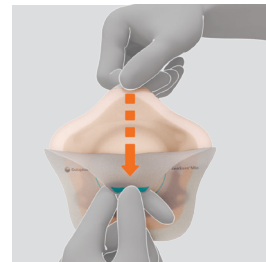

... and remove the protective film

Remove the protective film from the barrier

5



Position the barrier accurately

Hold the barrier with the petals folded back. Align the center part of the barrier around the stoma.

Press the center part carefully onto the skin. Then flip the petals down over the outward area.

6

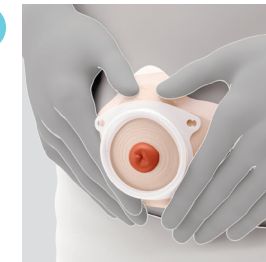

Press the barrier firmly onto the skin from the center and out.



Instruction for use also available on video

To see the instruction video you can either scan the QR code or go to

www.coloplast.us/convexflip/video/barrier

7

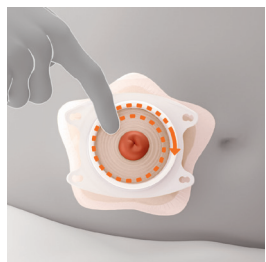

Seal the barrier securely

Place your index finger inside the coupling ring that surrounds your stoma. Carefully apply pressure on the barrier between coupling ring and your stoma to ensure the center part of the barrier forms a tight seal to the skin.

8

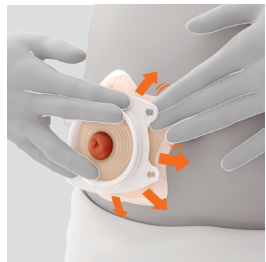

Ensure the fit

Apply pressure from the center of the barrier and outwards in multiple directions to ensure secure adhesion between the barrier and the skin around the stoma.

9

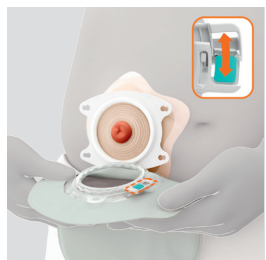

Position the pouch

Before applying the pouch, make sure the barrier is clean. Check that the lock ring is open.

Line up the bottom of the pouch coupling with the bottom of the barrier coupling.

Product features

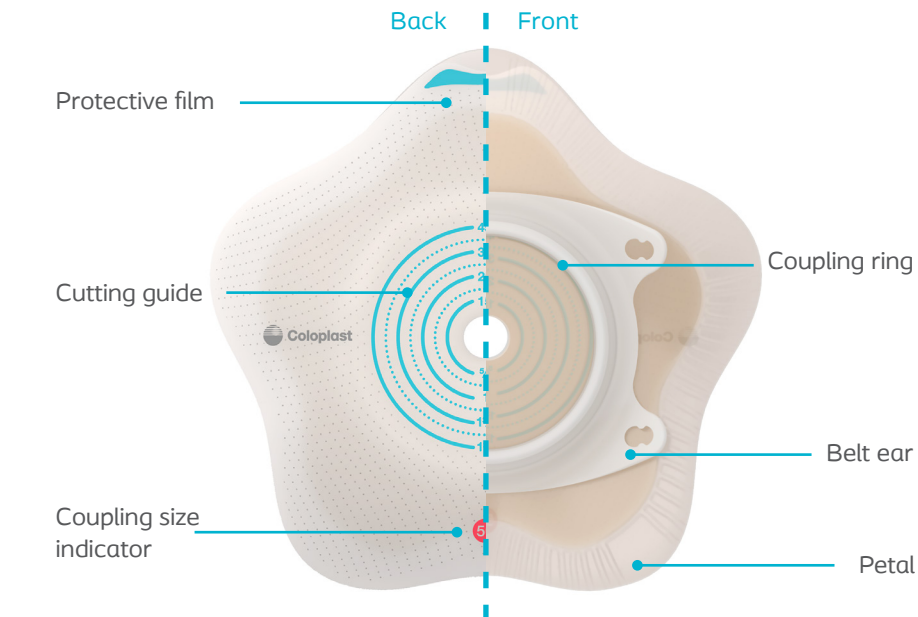

How to apply the pouch

10



Connect the pouch

Connect the pouch and the barrier together from the bottom with your middle fingers.

11

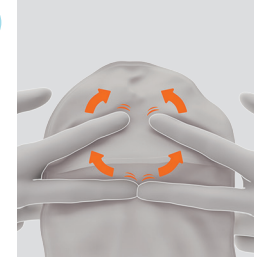

Scroll your fingers up

Scroll your index fingers upwards and apply gentle pressure to the top of the coupling **until you feel the pouch is securely fastened** to the barrier.

12

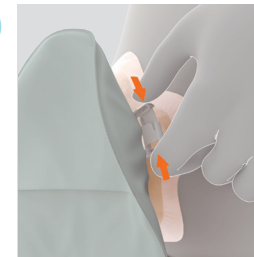

Click lock to secure

Close the lock ring by pressing the lock together. The pouch is securely attached to the barrier when you hear a 'click'.

Gently pull the pouch to check that it is correctly attached.

How to remove the pouch

1



Opening the lock-ring

Press the small turquoise tab facing your stomach with a finger tip to open the lock ring.

2

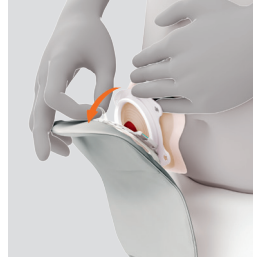

Removal of the pouch

Hold onto the pouch's removal ear and remove the pouch by **carefully pulling** the pouch away from the barrier.

More information on the pouch

For more information on how to use the pouch, please refer to the instruction for use that accompany the retail box for the pouch.

How to remove the barrier

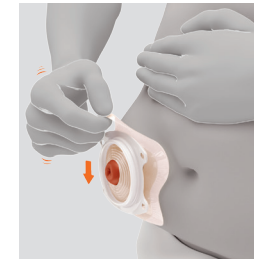

Remove the barrier

Gently remove the barrier by pulling the removal tab on the barrier away from the stomach and roll the barrier slowly downwards. Apply light pressure on your skin with your free hand to help removal.

Disposal



Disposing of the pouching system

The product is intended for single use only and should be disposed of with normal household waste.

Do not flush the product down the toilet.

Dealing with recurring issues

?

The barrier is not sticking properly to the skin

Make sure to follow the application instructions in this brochure and ensure the skin is completely clean and dry before applying. It's important that there is full contact between the barrier and every wrinkle of the skin. Put pressure on the barrier when applying to ensure sufficient adhesion.

?

The skin is red and/or irritated under the barrier

Irritated skin can have many causes. It can be caused by leakage from not using the right pouching system or the correctly-sized cutting template. But it can also be a result of insufficient cleaning or rapid removal of the adhesive which can stress the skin. If the skin is red, an adhesive remover might be helpful. Discuss the issue with your wound ostomy nurse as soon as possible.

?

Leakage under the barrier

Leakage can have many causes. It can be a result of the body or stoma changing shape or height, or an incorrect application of the barrier. Consider taking the online BodyCheck self-assessment at www.bodycheck.coloplast.us to see if your body profile has changed. If so, you might need a different pouching system, or you could benefit from a supporting product. Discuss the issue with your wound ostomy nurse as soon as possible.

General product information

!

Store product horizontally.

!

Keep away from sunlight.

Coloplast accepts no liability for any injury or loss that may arise if this product is used in a manner contrary to Coloplast's current recommendations.

Warnings

Re-use of the single use product may create a potential harm to the user. Reprocessing, washing, disinfection and/or sterilization may compromise product characteristics, causing additional risk of physical harm or infection to the user.

Distributed by
Coloplast Corp
1601 West River Road North
Minneapolis, MN 55411 USA
www.coloplast.us
Tel. 1-800-533-0464



Manufacturer



Catalog number



Batch code



Horizontal storage



Do not re-use



Date of manufacture



Consult instructions for use



Use-by date

23320947 Version 1
2018-07-31

The Coloplast logo is a registered trademark of Coloplast A/S. All rights reserved. ©
Velcro® is owned by Velcro Industries B.V.



SenSura® Mio Convex Flip

All you need to know

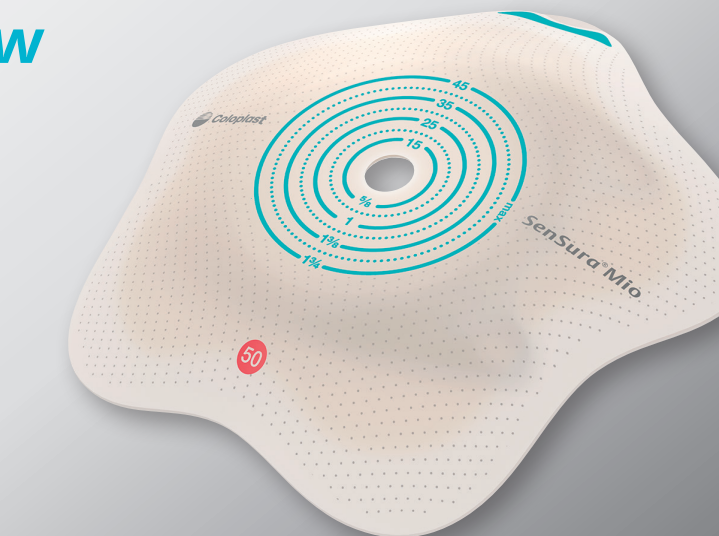

Convex Flip ostomy barrier
2-piece click barrier - instruction for use

