



# LED Exam Light

## INSTALLATION & OPERATION MANUAL

### IMPORTANT INFORMATION

#### GENERAL

The LED Exam Light features a high intensity, low voltage bulb providing best in class bright, clear light. The long-life LED bulb ensures a low cost of ownership, and the easy-to-clean surface and maneuverability improves efficiency.

Other features include:

- Flexible, “no-drift” gooseneck offering superior beam alignment.
- Rotation of the light head and gooseneck arm allows for easy positioning of the light source.
- Cool, safe lighting.
- Power cord exits the weighted base at floor level.
- Optional compact, 5-leg caster base for increased mobility.

#### MODEL & SERIAL NUMBER

The model number and serial numbers are located on the underside of the base. The serial number will start with EC followed by six digits: EC#####.

#### SERVICE

If you require assistance with the installation or operation, call Technical Support at 1.888.273.9371. Our trained staff will assist you in correcting the problem directly over the phone. If service is required, a factory authorized technician will be sent to your location.

Please fill in the following information for use when calling Customer Service or your distributor with questions regarding your unit.

Date of Purchase: \_\_\_\_\_  
Serial Number: \_\_\_\_\_  
Model Number: \_\_\_\_\_  
Distributor Name: \_\_\_\_\_  
Distributor Phone Number: \_\_\_\_\_



## SPECIFICATIONS

Wattage - LED ..... 12W  
Color Temperature..... 4000° K Minimum  
Lux (LED)..... 19375 @ 18"

Rotation, Light Head .....340°  
Arm Design .....Gooseneck

## ELECTRICAL REQUIREMENTS

The electrical rating for this unit is 120 VAC, 60 Hz, 0.2 amps. The three pronged grounding plug on the power cord must be plugged into a matching three-pronged, grounded, non-isolated, correctly-polarized 115 VAC receptacle.

 <b>CAUTION</b>	
	<b>Shock and Damage Hazard</b> Using power supply other than that listed on the rating label could result in serious injury or equipment damage.

<b>NOTICE</b>
These products have been evaluated with respect to electrical shock, fire, and mechanical hazards only in accordance with UL 153; CAN/CSA C22.2 no. 12 or UL 1598.

## SAFETY INFORMATION

The primary concern is that the equipment is operated and maintained with the safety of the patient and healthcare staff in mind. To ensure safe and reliable operation:

- Read and understand all instructions in this manual before attempting to install or operate the unit.
- Ensure that appropriate personnel are informed on the manual contents and are familiar with proper operation of the unit before use. This is the responsibility of the purchaser.
- Ensure that this manual is located near the unit.

**Failure to follow instructions with this symbol  could result in serious personal injury and/or damage to the unit.**

 **DANGER** indicates a hazardous situation that, if not avoided, will result in death or serious injury.

 **WARNING** indicates a hazardous situation that, if not avoided, could result in death or serious injury.

 **CAUTION** indicates a hazardous situation that, if not avoided, could result in serious injury and/or equipment damage.

## UNPACKING AND ASSEMBLY

<b>NOTICE</b>
To avoid damaging the unit or painted surfaces, <b>DO NOT</b> use a knife or other sharp object to open the packaging.

1. Slide protective plastic clear of gooseneck with lighthead/upright pole connection point.
2. Screw gooseneck with lighthead firmly into upright pole, making sure there is no gap at the joint.
3. Slide protective plastic clear of upright pole/base connection point.





<b>NOTICE</b>
Inspect all boxes and contents for damage. Report any damage to the carrier immediately.

4. Push excess cord into base.
5. Screw upright pole/gooseneck with lighthead assembly firmly into base.
6. Remove all protective packaging.
7. Plug power cord into inlet on side of base.

## OPERATION

1. Plug power cord into appropriate size electrical outlet.
2. Turn switch, located at back of light head, to the ON position.
3. Adjust location of light by grasping vinyl coated gooseneck and bending to desired location.
4. Do not lift the light by the gooseneck to move it. Please grasp light by the rigid upright pole that is attached to the base.

## MAINTENANCE

 <b>WARNING</b>			 <b>WARNING</b>	
		<b>Burn and Electric Shock Hazard.</b>  Failure to unplug light and to allow bulb to cool before servicing could cause serious injury.		<b>Fire Hazard</b>  The maximum allowable bulb wattage is 12 watts. There is risk of fire if the 12 watt limit is exceeded. Only use replacement bulb part# 2102755.

## BULB REPLACEMENT

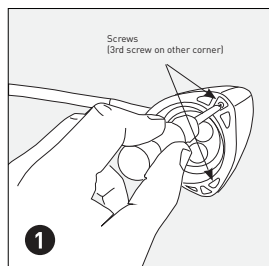

**Bezel Screw Locations**

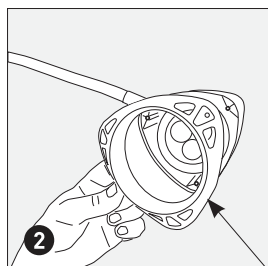

**Remove Bezel**

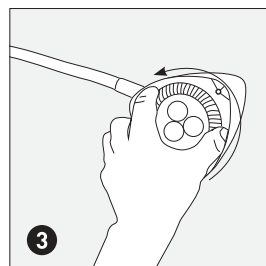



**Remove Bulb**

1. Unplug light and allow it to cool before servicing.
2. Remove the (3) screws that secure the bezel to the lighthouse (figure 1).
3. Pull bezel from lighthouse (figure 2).
4. Unscrew LED bulb (figure 3).
5. Replacement is the reverse of steps 2-3.

**NOTE: REPLACE ONLY WITH LED BULB PART NUMBER 2102755.**

## CLEANING

 <b>WARNING</b>		
		<b>Burn and Electric Shock Hazard</b>  Before cleaning or disinfecting, unplug the light and allow lighthouse to cool. Clean EXTERNAL SURFACES ONLY. Prevent fluids from leaking into interior or onto electrical parts. DO NOT ATTEMPT to clean or disinfect interior; instead call an authorized dealer or service technician.

For cleaning and disinfecting instructions please see the **Cleaning Guidelines** at [www.brewercompany.com](http://www.brewercompany.com).

## SERVICE PARTS

Bulb, LED (qty. 1) ..... P/N 2102755

Power Cord, Detachable ..... P/N 2102756

## TROUBLESHOOTING

### LIGHT DOES NOT TURN ON.

- Make sure power cord is connected to outlet and light base, and that outlet is functioning.
- Check the circuit breaker for the outlet (if outlet is not functioning).
- Check the power cord for damaged insulation; replace if necessary.
- Verify bulb is functional and installed properly. Make sure bulb is cool before checking proper installation.
- Replace light bulb. If problem persists, call Technical Support at 1.888.273.9371.
- Failed wire or connector, call Technical Support at 1.888.273.9371.
- Verify continuity from connector in base through light head.

⚠ CAUTION		
	<b>Shock and Damage Hazard</b>	<ul style="list-style-type: none"><li>• Periodically inspect the electrical cord for cuts or damage.</li><li>• Inspect mechanical functions to ensure satisfactory operation.</li><li>• Check fasteners to make sure they are present and tighten securely.</li></ul>
	Failure to perform periodic inspections of the light could result in personal injury or equipment damage.	

## WARRANTY

### GENERAL TERMS AND CONDITIONS

**Warranty:** McKesson Medical-Surgical shall manufacture the Products in accordance with the requirements of all applicable law, including without limitations, the regulations promulgated by and for the Federal Food and Drug Administration and industry standards. McKesson Medical-Surgical warrants its Products to be free from defects in parts and workmanship under normal use and service for a period detailed in the table below from the date of delivery to original end user. McKesson Medical-Surgical will not be responsible for any Product failure due to abuse, modification or improper use, or for any use which exceeds the published capacity of the Product.

Do not discard parts before contacting McKesson Medical-Surgical for warranty service, as McKesson Medical-Surgical may require the customer to send in defective parts for examination to determine the applicability of these warranty provisions. If this occurs, the customer will be invoiced against a new purchase order for the replacement part. If the part is found to our satisfaction to have been defective under the terms of the warranty, the customer will be credited the amount of the replacement part and outbound shipping costs. If the part is found not to be defective under the terms of this warranty, the customer is liable for the cost of the replacement part, shipping, and/or any repair costs.

Product	Warranty Registration Required	Warranty Period
Lighting	No	1 Year

This warranty is exclusive and in lieu of all other warranties and remedies whatsoever, including but not limited to implied warranties for merchantability and/or fitness for a particular purpose. No agent, employee, or representative of McKesson Medical-Surgical has any authority to make any affirmation, representation, or warranty not set forth in these terms and conditions concerning any products of McKesson Medical-Surgical. McKesson Medical-Surgical shall have no liability whatsoever for damages caused by transportation, accidents, fire, unauthorized alteration, or normal wear or abuse. McKesson Medical-Surgical will have no liability whatsoever for any incidental or consequential damages, including without limitation, lost profits or any such damages arising from (a) the design, manufacture, sale, delivery, installation, repair, operation or use of Products of McKesson Medical-Surgical or any part thereof, (b) any actual or alleged failure or defect in Products of McKesson Medical-Surgical or any part thereof, or (c) any actual or alleged breach or non-performance by McKesson Medical-Surgical of this limited warranty.

**Freight Claims:** Upon receipt, merchandise should be carefully examined to ascertain that proper amount has been received in good condition – once the delivery receipt is signed free and clear, no freight claims can be made. Any claim for shortage or damage must be made with delivering carrier within five (5) days from receipt of goods. McKesson Medical-Surgical does not assume any responsibility for loss or damage in transit, and compensation for such loss must be obtained from the freight carrier.

Questions? Call 1-800-777-4908  
Technical Support? Call 1-888-273-9371

<b>■ Satisfaction Guaranteed</b>
If you are not completely satisfied with any McKesson Brands product, you may return it for a full refund or credit.

Distributed By McKesson Medical-Surgical Inc.  
Richmond, VA 23233  
Rev. 00 05/16  
Made in China